

the
future
is now



CAPITANI
MINUTERIE METALLICHE

Our small metal parts travel together with thousands of people all over the world. They are often hidden or so small they go unnoticed, but they still need to be perfect.

At Capitani Minuterie Metalliche, we are committed to making small metal parts of the highest quality, and we do it with the strength of over fifty years of experience.

This commitment is reflected in our products but also in the values that guide our work: we invest in the continued training of our collaborators to guarantee their skills and innovation. We also create comfortable, safe work spaces to promote wellness in our team, and our work is always attentive to sustainability, implementing responsible practices to protect the environment and play our part in building a greener future.





CAPITANI
MINUTERIE METALLICHE

CAPITANI
MINUTERIE METALLICHE

5
↓
SCARICO

ALLA
CONTINUAZIONE
CARICO &
SCARICO
UFFICI



We are present in our area and
we respect the environment:

THESE ARE NOT FUTURE GOALS BUT
VALUES THAT HAVE BEEN OURS FOREVER.



sustainability



At Capitani Minuterie Metalliche, we are committed, on a daily basis, to reducing the impact of our activities on the environment, with a production model that is more respectful of resources on the planet. Thanks to our photovoltaic system, we make some 32% of our electricity needs ourselves, meaning average savings of some 40,000 kg of CO2 every year.

Our vacuum chamber washing machine, as well as reducing the workload for our operators, has allowed us to limit the consumption of chemicals to just a few litres every year, and also to lower electricity consumption by about 50% compared to a traditional washing machine. Lastly, with our modern de-oiling system, we can recover about 77,059 litres of oil every year and transform shavings into a precious raw material. This takes the production of hazardous waste practically to zero.

OUR COMMITMENT TO THE ENVIRONMENT

32%

self-produced energy
in relation to total requirements

100%

raw materials
recovered

all machining waste
in the form of shavings,
is recovered and recycled

0%

special waste

no liquid waste, no solvent
residues on products or in
the environment

Systems used

590 M 2 SOLAR PANELS

VACUUM WASHING MACHINE

DE-OILING SYSTEM AND CENTRIFUGE FOR SHAVINGS

TRANSPARENT
AND RESPONSIBLE
SINCE 2022



Find out more about our Sustainability Reports

RATING ESG

A seguito dello studio effettuato dal Comitato Scientifico sulla base dei dati raccolti, siamo lieti di attestare che la

CAPITANI MINUTERIE METALLICHE S.R.L.

ha ottenuto in data 16/10/2024 il Rating di Sostenibilità ESG con il giudizio di seguito riportato

BBB

ESG	AMBIENTE	SOCIALE	GOVERNO SOCIETARIO
53/100	[E] 41/100	[S] 63/100	[G] 54/100

BBB

E' stato intrapreso un percorso di sviluppo che permetterà di allinearsi con le normative ESG. L'azienda deve concentrarsi maggiormente sul migliorare la propria sostenibilità e sull'informativa nei confronti degli stakeholder.

L'ottenimento del Rating ESG è un primo grande passo verso un percorso di sviluppo e sostenibilità che la CAPITANI MINUTERIE METALLICHE S.R.L. ha iniziato a intraprendere con coraggio e dedizione.

Il presente Rating è stato processato attraverso la piattaforma Ecomate The Open-ESG Rating.

Our sustainability report aims to highlight the results determined by objectives for continued evolution within the company. These goals are based on the wellness of people, respect for the environment, and on a positive impact on the area, in line with the company vision: to make Capitani an ideal workplace.

The report provides the latest figures that follow international standards, to give us and our stakeholders a clear and objective picture of the current situation within the company. For example, some interesting figures: production capacity, increased workforce with the hiring of new staff, investments, and the strategic choices that have made it possible to further reduce our impact on the environment. The report also includes support devolved in favour of our local community, since we firmly believe in the area and the quality of social relations that can be established in a healthy, positive environment, able to look to the future.

Further acknowledgement of our commitment to sustainability is the fact that we have achieved an ESG rating of 53/100, which places us among the companies with mid-level environmental and social performance and governance. This opinion, issued by specialised rating agencies reflects the suitability of our practices vis-a-vis international sustainability standards. Our BBB rating is a positive signal that certifies our continuous commitment, and it motivates us to continue on our pathway to growth.

BILANCIO DI SOSTENIBILITÀ

2023

301,3

Prodotti recuperati e relativi materiali di confezionamento

Il nuovo impianto di filtrazione ci permette di recuperare circa 10.000 litri di olio all'anno e di trasformare il truciolo in preziosa materia prima. Infatti, vendiamo gli sfridi di produzione a operatori che li trasformano in barre di ottone che, in base all'esperienza produttiva della nostra società, ricicliamo. La quantità di sfridi inviati al recupero è inserita nell'informativa GRI 306. Inoltre, abbiamo sostituito i pluriball di plastica con imballaggi in carta.

BILANCIO DI SOSTENIBILITÀ

2023

Highlights

FORNITORI ITALIANI 100%

MATERIA PRIMA ACQUISTATA DA FORNITORI REGIONALI 80%

3 MWh CONSUMATI PER TONNELLATA DI MATERIA PRIMA LAVORATA

CO₂ 28 PER TONNELLATA DI MATERIA PRIMA LAVORATA

45 t R

+6

130 MEDIA ORE IN FORMAZIONE PER DIPENDENTE



BILANCIO DI SOSTENIBILITÀ

2023

DATI AMBIENTALI

Generating loyalty and establishing
lasting relationships:

THESE ARE FUNDAMENTAL VALUES
IN OUR COMPANY VISION.

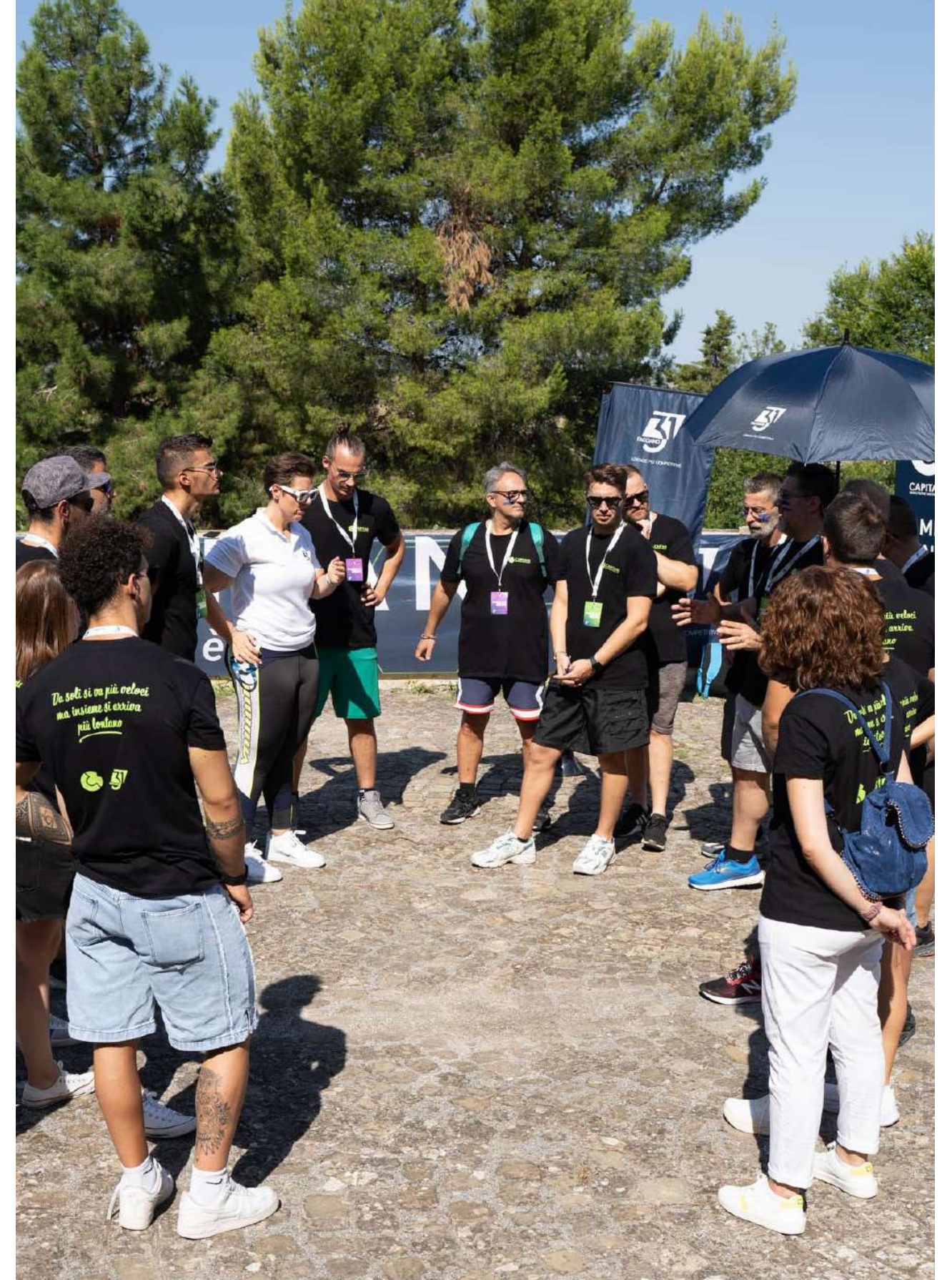

people



From the very beginning, our business has always placed a great deal of importance on relationships and people: not just customers but above all, collaborators. These people, whether more experienced or younger members of our workforce, are the true strength of Capitan. The young age of half of our team, ranging between 20 and 35 years, means we are able to stay constantly innovation-orientated in terms of technology.

Every one of them is part of our corporate growth plan, bringing their personality, talents and skill-sets to the table, with a constructive spirit. Growing as a group means placing a high value on training, which involves every member of the team. We have decided to focus on operating efficiency, the use of new tools, and on safety.

Collaboration and the feeling that we are all in it together are what drive us always to do better, and they are also what bring us to work every day with a smile.



Not just production plants:

WE SHARE AREAS FOR DIALOGUE,
GET-TOGETHERS, AND WELL-BEING.

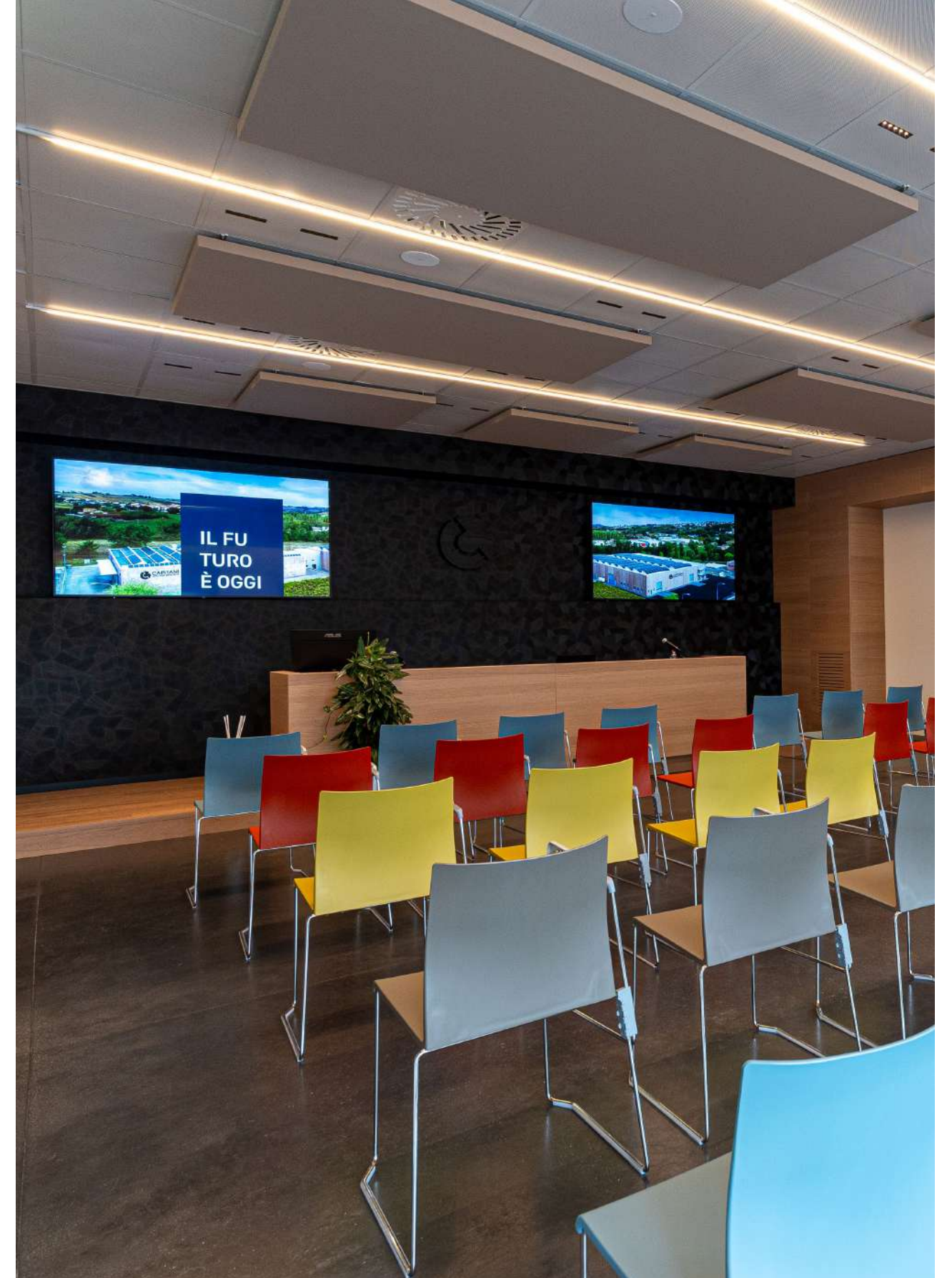

dedicated areas



At Capitani Minuterie Metalliche, we work hard to create a work environment that fosters the well-being and productivity of our employees and guests. A well-equipped company kitchen offers a welcoming space for a restorative break. And for those who like to keep fit, there is also a gym with professional equipment. The conference and meeting rooms have the best technologies to guarantee productive meetings and collaboration.

And for collaborators and suppliers, we can make offer comfy apartments that are ideal to make their stay a pleasant one during their visits to the company. Constant attention to comfort and quality of life is at the heart of our philosophy.

220,000 small metal parts turned every day, a customer base of over 300 companies, and an increasingly specialised work team:

**CAPITANI MINUTERIE METALLICHE
IS A CONTINUOUSLY DEVELOPING
COMPANY, BASED IN THE MARCHE.**



evolution

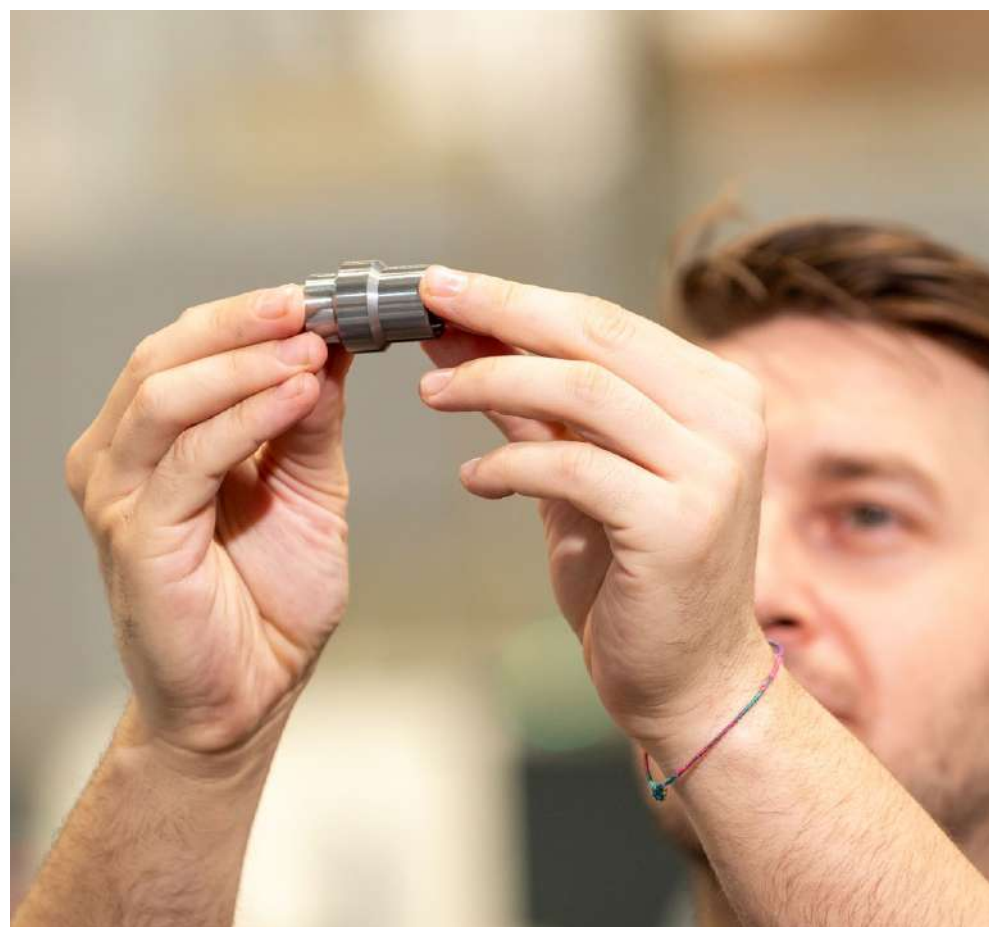
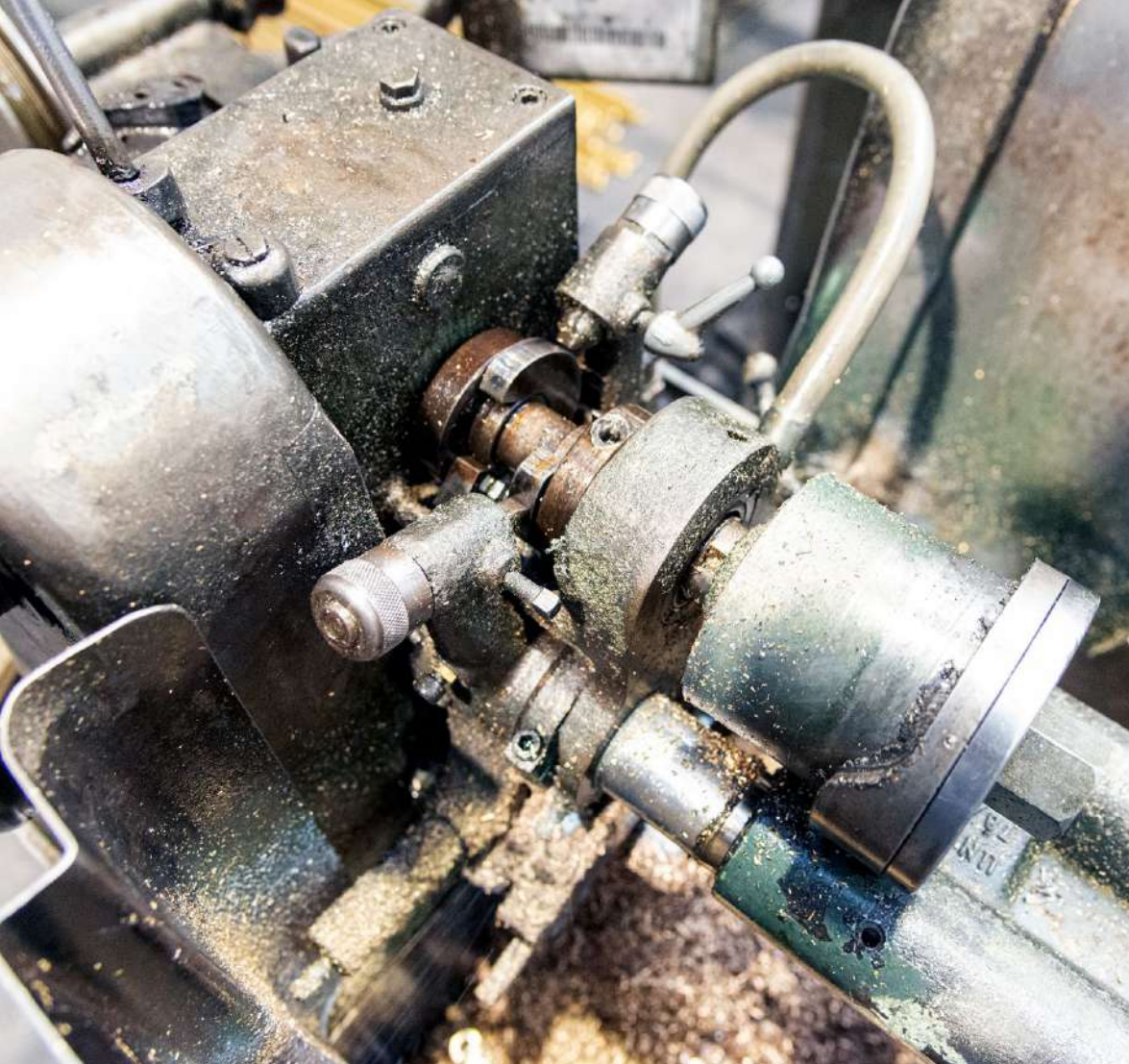

The story of Capitani is a lot like that of many other companies based in the Marche region, born of the entrepreneurial spirit of our founder, Eraclio, with just two lathes and a screw machine in his garage at home.

From 1969 to the present day, the many challenges that we have accepted have turned what was a small artisan business into a high-tech industrial concern, with twenty-eight collaborators and a plant some 14,000 m² in size, of which 6,500 m² are dedicated to production.





Handing over to the next generation has today made Capitani a modern company that never stops calling itself into question. At Capitani, tools, methods and production processes are always examined with a critical eye, with the aim of improving the working environment for us and the quality of our products for our customers.



41 CNC machines, all
interconnected, together
with 38 automatic lathes:

TRADITION AND FUTURE TRAVEL
TOGETHER ON PARALLEL LINES
IN OUR PRODUCTION PLANT.

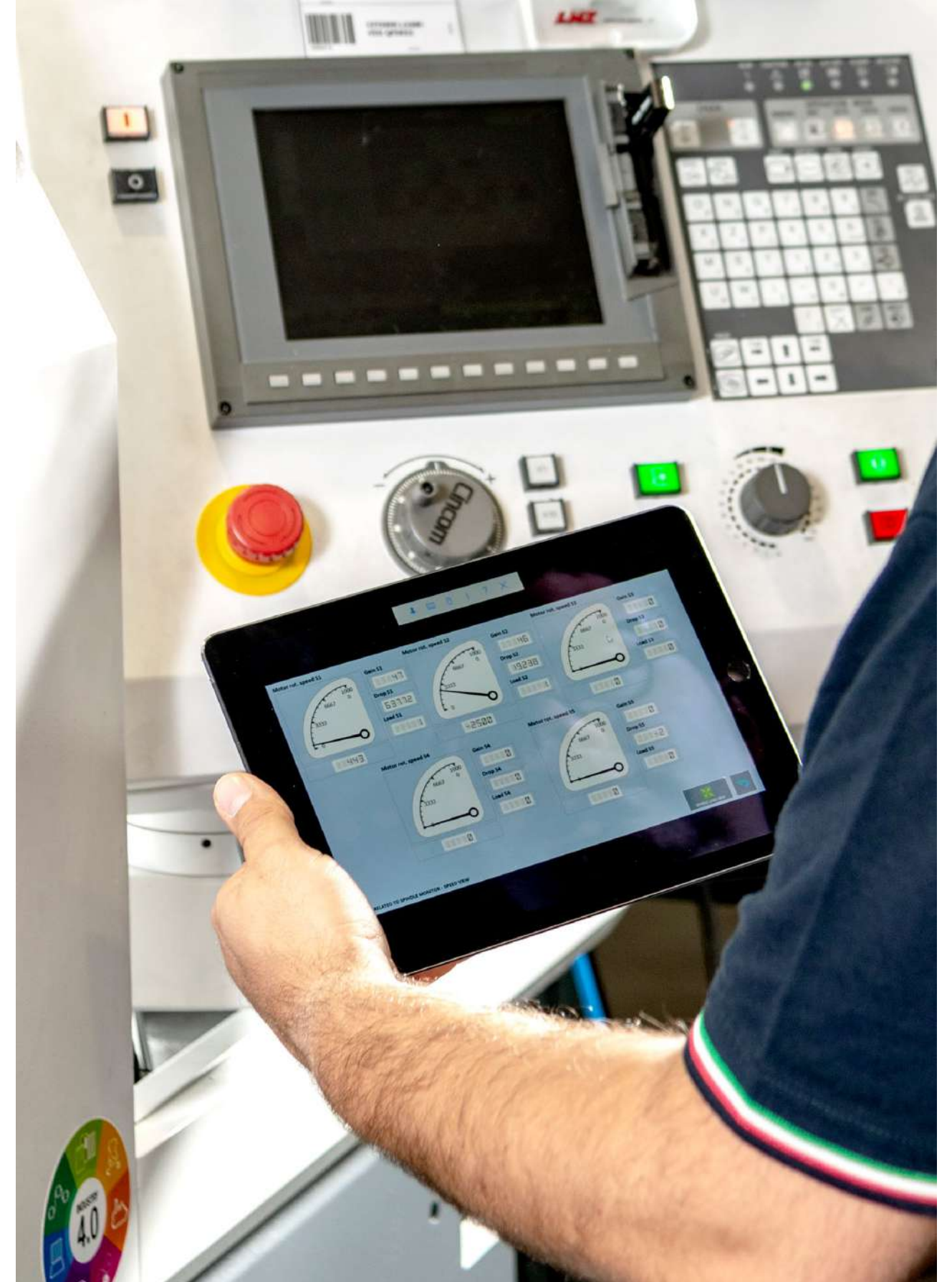

production



Automation, connectivity and remote control are the cornerstones of a production process in our company, where we aim for increased efficiency in terms of turnaround time, finished product quality and the quality of the workplace environment. Thanks to interconnection and the use of dedicated software, we are able to keep every stage of the work flow under control, and this allows us to make accurate forecasts on the progress of jobs.

In spite of this transformation in technology terms, we have not decommissioned our old production division: we still have a fully operational line of automatic lathes for specific products and to supply from just a few thousand to tens of thousands of pieces, and which help us to provide a prompt response to even the most urgent requests.



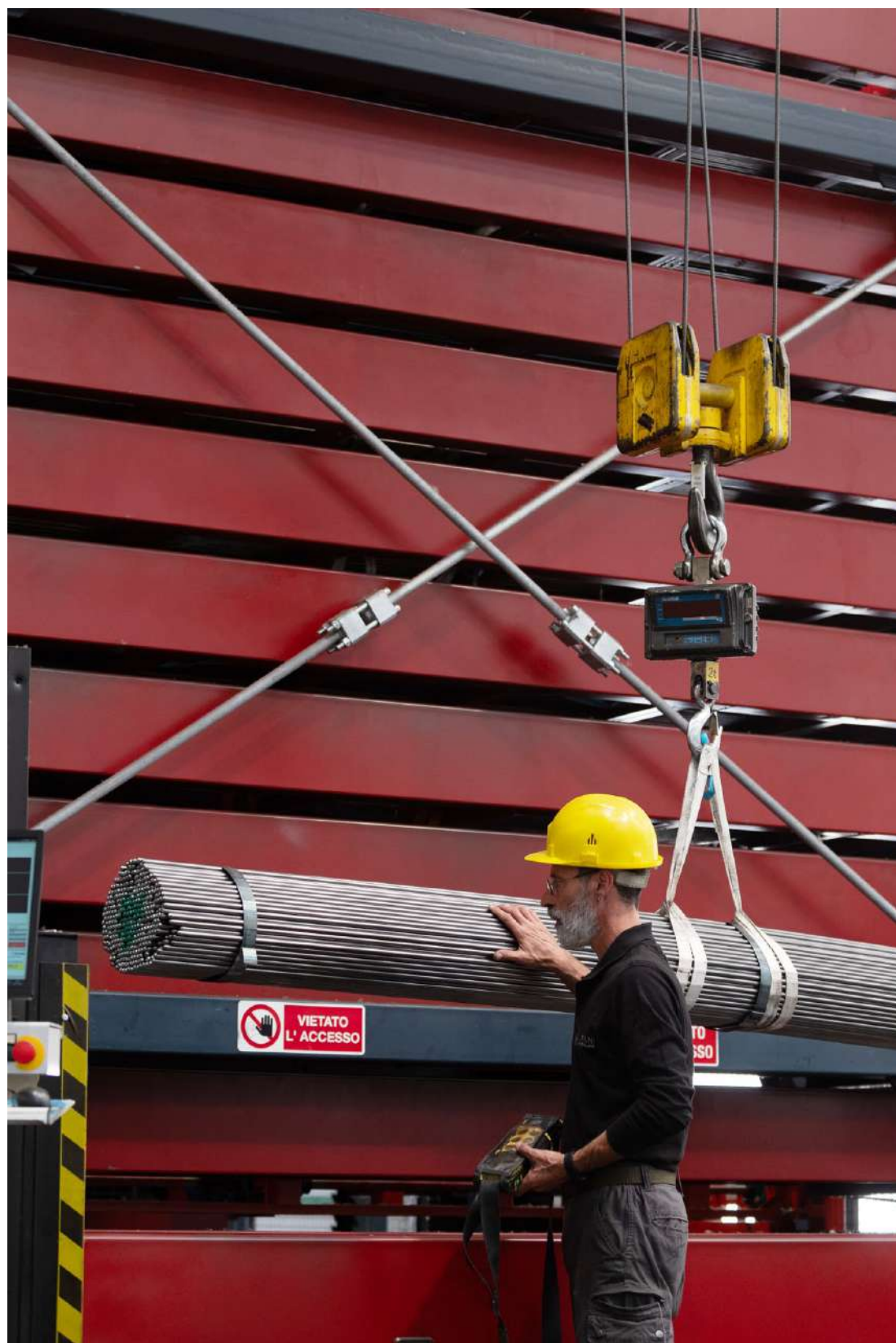

Work flow planning and monitoring are part of our strategy to boost productivity and guarantee that we respect commitments made to our customers. The same strategy also includes investment in machinery to support production:

- ▶ Automatic warehouse for handling raw materials
- ▶ Electronic drawers to trace tool use
- ▶ Two four-axis tool grinding machines to shape bits to drawing

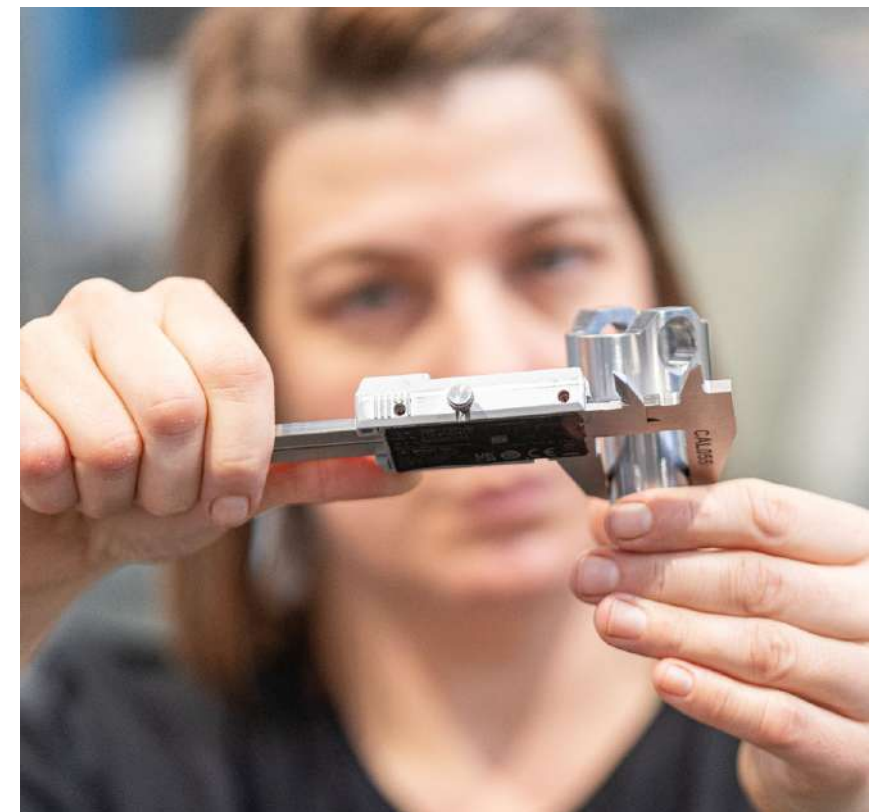
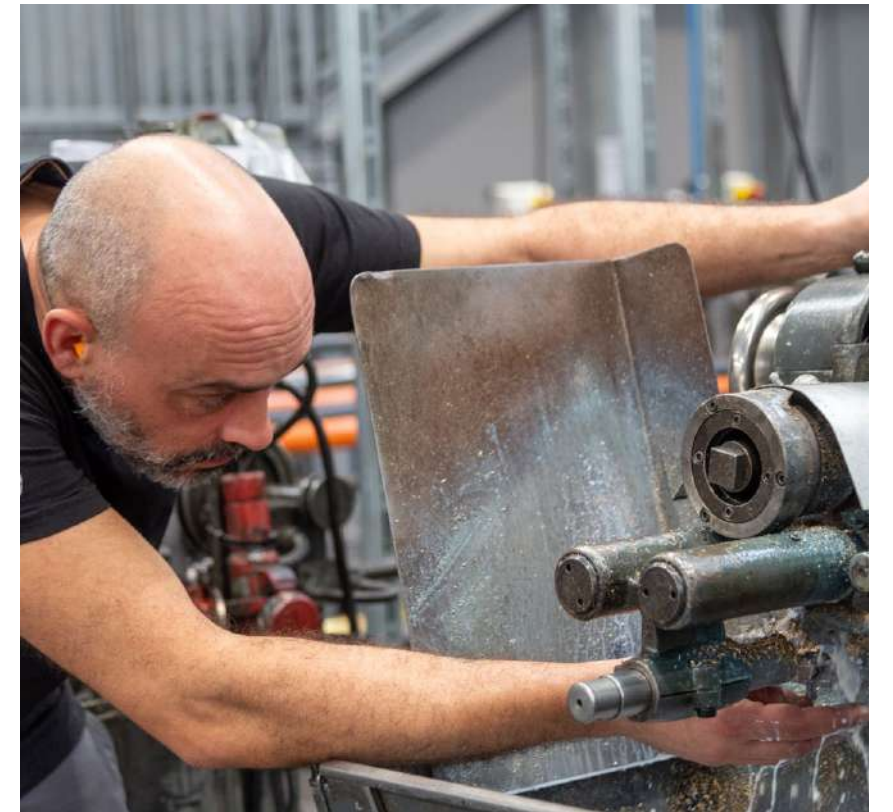

OUR CONSTANTLY CHANGING
MACHINE STOCK

N.	Name	Type	Ø max
1	CITIZEN K16E-VII	FANTINA CNC LATHE	16
1	MIYANO BNA-42MSY	CNC FIXED HEAD TURNING LATHE	42
2	MIYANO BNA-42DHY3	CNC FIXED HEAD TURNING LATHE	42
1	CITIZEN L12-VII	FANTINA CNC LATHE	12
5	CITIZEN L32-VIII L32-1M8	FANTINA CNC LATHE WITH HIGH PRESSURE	32
2	CITIZEN L32-XII MOD. L32-1M12	FANTINA CNC LATHE WITH HIGH PRESSURE	32
7	CITIZEN L20E-2M10	FANTINA CNC LATHE	20
2	CITIZEN L20E-2M10	FANTINA CNC LATHE WITH HIGH PRESSURE	20
8	CITIZEN A20	FANTINA CNC LATHE	20
2	CITIZEN A20	FANTINA CNC LATHE WITH HIGH PRESSURE	20
6	ITS TCN	CNC FIXED HEAD TURNING LATHE	32
1	CMZ-TTL-52	CNC FIXED HEAD TURNING LATHE	52
2	CMZ TA-20-YS-640	CNC FIXED HEAD TURNING LATHE	65
1	CMZ-TTL-66	CNC FIXED HEAD TURNING LATHE	65

N.	Nome	Tipo	Ø max.
3	UNAMUNO TA25	CAM-DRIVEN LATHE	25
4	UNAMUNO TA26 PREMIUM	CAM-DRIVEN LATHE	26
1	IRALAG TA45	CAM-DRIVEN LATHE	45
1	ITS TCA 26	CAM-DRIVEN LATHE	26
7	UNAMUNO TA16C	CAM-DRIVEN LATHE	16
2	FEINLER TA10	CAM-DRIVEN LATHE	10
20	FEINLER TA15	CAM-DRIVEN LATHE	15
10	PUNCH MACHINES		
30	THREADING MACHINES		

N.	Nome	Tipo
1	IFP KP 100 HMA	AUTOMATIC VACUUM WASHING MACHINE
1	IFP KP 100 HMA CON PROTETTIVO	AUTOMATIC VACUUM WASHING MACHINE
1	CONTOUR 305	OPTICAL MEASUREMENT MACHINE
1	CONTOUR CS314LC	OPTICAL MEASUREMENT MACHINE
1	DIMAC MCV5	OPTICAL SELECTION SYSTEM
1	DATAGEST-DGSORT/W	OPTICAL SELECTION SYSTEM
1	BOWMAN	X-RAY INSTRUMENT FOR THICKNESS ANALYSIS
1	CUOGHI - MAC26	FOUR-AXIS TOOL GRINDER FOR HSS
2	CUOGHI - MAC26	FOUR-AXIS TOOL GRINDER FOR HARD METAL [WITH INDUSTRY 4.0]
1	AUTOMATOR NANO VISII	LASER MARKING MACHINE - CLASS 4



From nuts to precision-turned,
small metal parts: different levels
of complexity to which we dedicate
the same attention.

BEHIND EVERYTHING WE MAKE,
THERE IS IN-DEPTH KNOWLEDGE
OF RAW MATERIALS AND
PRODUCTION PROCESSES.

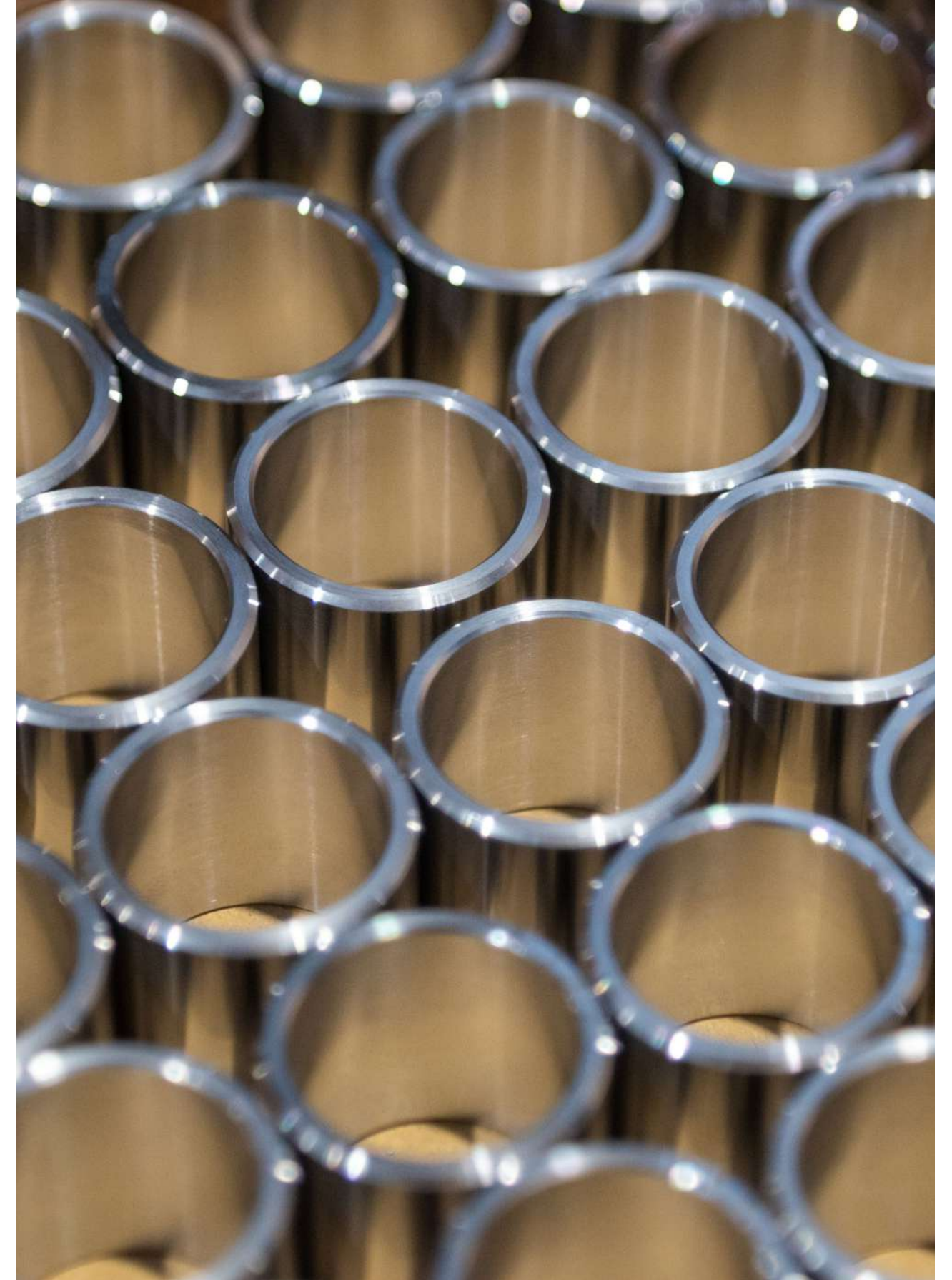

precision



We produce small metal parts turned to design, according to customer specifications, and more besides. Thanks to our thorough knowledge of materials and processes, our technical division is able to work alongside our customers and support them in solving any design or production problem.

MACHINING

- ▶ Lapping
- ▶ Grinding
- ▶ Assembly

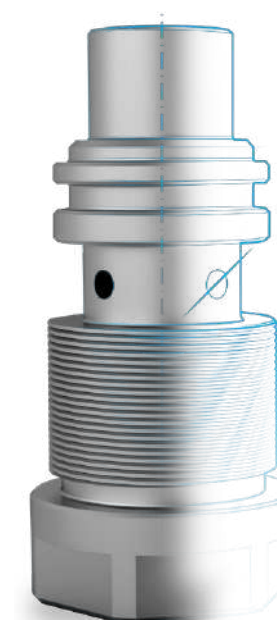

TREATMENTS

Thanks to our partnerships with other companies, we are able to provide, on request, finished products with the following surface finishes:

- ▶ Galvanizing
- ▶ Nickel plating
- ▶ Nickel galvanizing
- ▶ Bluing
- ▶ Copper plating
- ▶ Geomet®
- ▶ Annealing
- ▶ Case hardening
- ▶ Nitriding
- ▶ Tempering
- ▶ Phosphate conversion coating
- ▶ Tin plating
- ▶ Anodic oxidation
- ▶ Chrome plating
- ▶ Alodine
- ▶ Passivation





PRODUCTIVITY

Data as at 2024

60 Mln
small metal parts

2.260
shipments



AREAS OF REFERENCE

- Railway industry
- Automotive
- Electronics
- Plumbing and heating
- Electrical
- Hydraulic
- Agriculture machinery
- Lighting industry



RAW MATERIALS USAGE

TOTAL RAW MATERIAL USAGE IN 2024: 751,8 tons
OF WHICH:

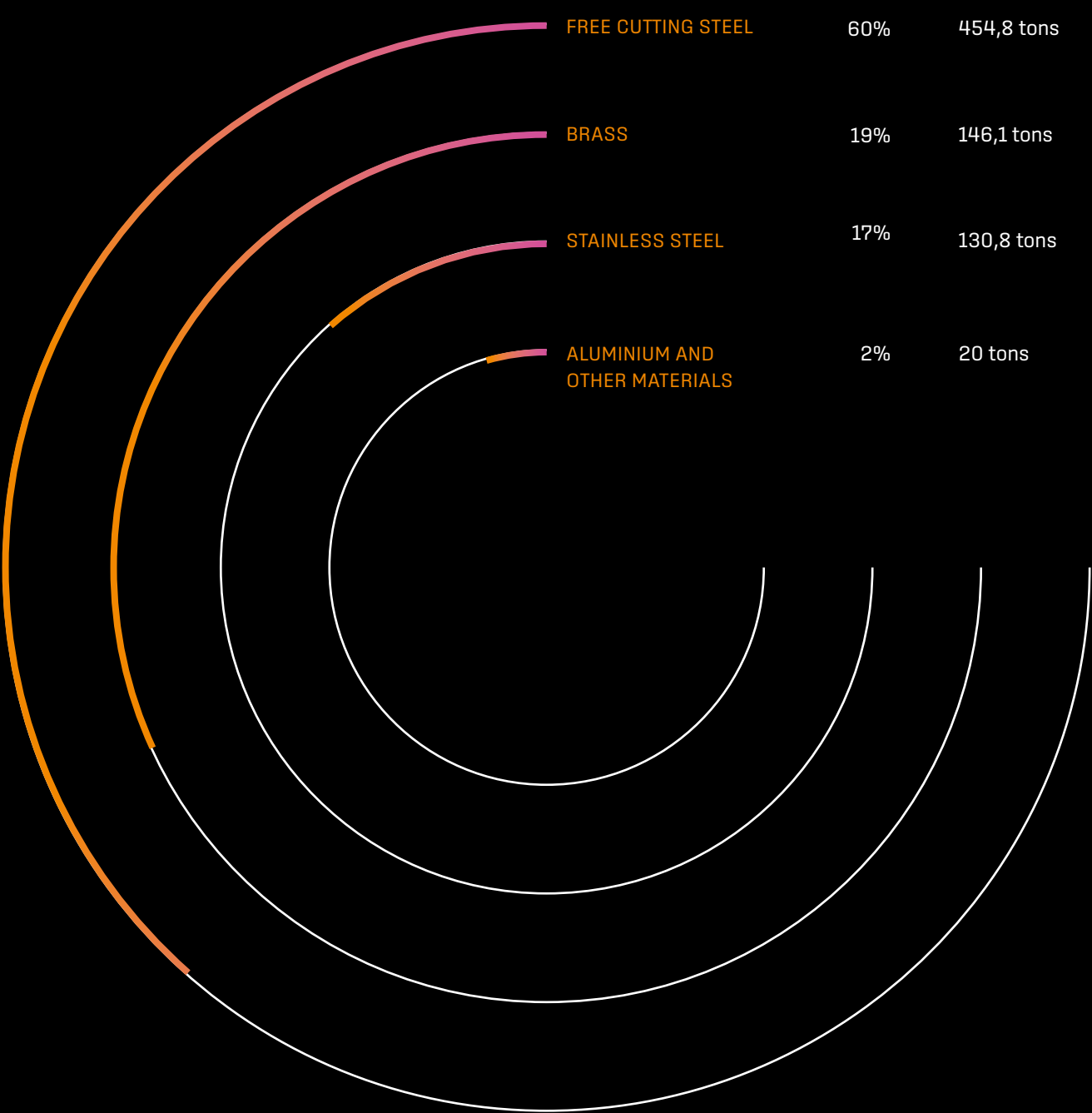

FREE CUTTING STEEL NOT DESTINED FOR HEAT TREATMENT			
	Europe	N°	
11SMn30	11SMn30	1.0715	▲
Led 108	11SMnPb30	1.0718	▲
AVZ	11SMn37	1.0736	▲
AVP - PS113	11SMnPb37	1.0737	▲
Telby	11SMnPb30+Te+Bi	1.0718	▲
Telby Plus	11SMnPb37+Te+Bi	1.0737	▲
FE37 - RE37	S235JRG2C	1.0038 - 1.0122	▲
FE52 - RE52	S355J2G3C	1.0570 - 1.0569	▲

FREE CUTTING STEEL FOR TEMPERING			
	Europe	N°	
PR80 - SAE1137 Pb	36SMnPb14	1.0765	▲
C40 - KV45	C45E	1.1730 - 1.1191	▲
USIMAX	38SMn28	1.0760	▲
RB2Pb	39NiCrMo3 Pb	-	▲
RK3	100Cr6	-	▲

FREE CUTTING STEEL FOR CEMENTATION			
	Europe	N°	
RN2Pb	16NiCrS4 Pb	1.5715	▲
20MNCRS5	20MnCrS5	1.7149	▲
RC2	18NiCrMo5	1.6566	▲

MARTENSITIC STAINLESS STEEL			
	Europe	N°	
430F	X14CrMoS17	1.4104	▲

AUSTENITIC STAINLESS STEEL			
	Europe	N°	
303 PLUS	X8CrNiS18-9	1.4305	▲
304L	X2CrNi18-9	1.4307	▲
316L	X2CrNiMo17-12	1.4404	▲

OTHER MATERIALS			
	Europe	N°	
BRASS	CuZn39Pb3	CW 614 N	
POM	DELRIN		
ALUMINIUM	Lega 2011		
ALUMINIUM	Lega 6082 Anticorodal		

239.2 tons of raw materials available
in our warehouse, and 1,020 item codes
in stock and ready for shipping:

AT CAPITANI WE KNOW ALL ABOUT
THE NEEDS OF OUR CUSTOMERS.

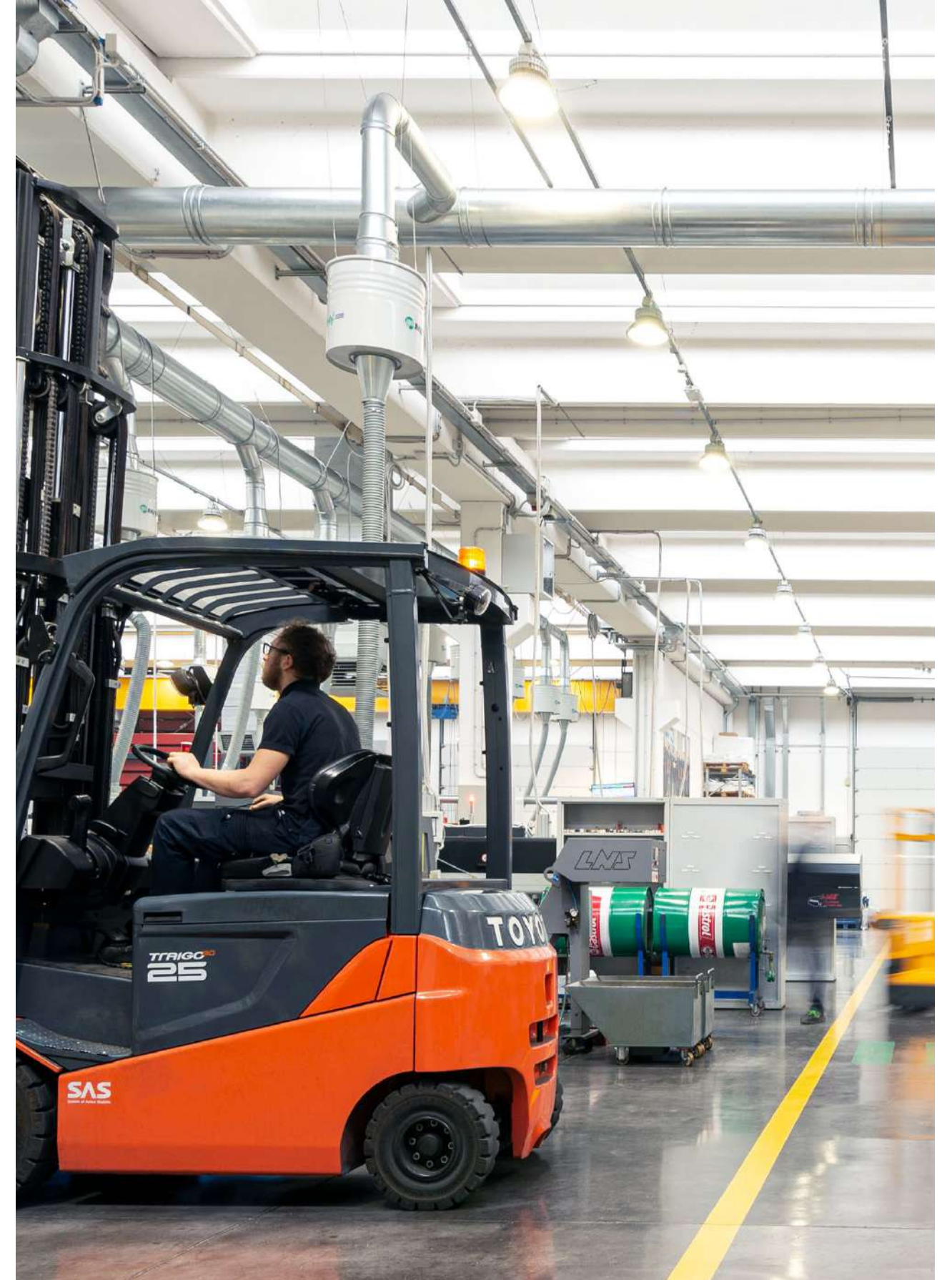

progress

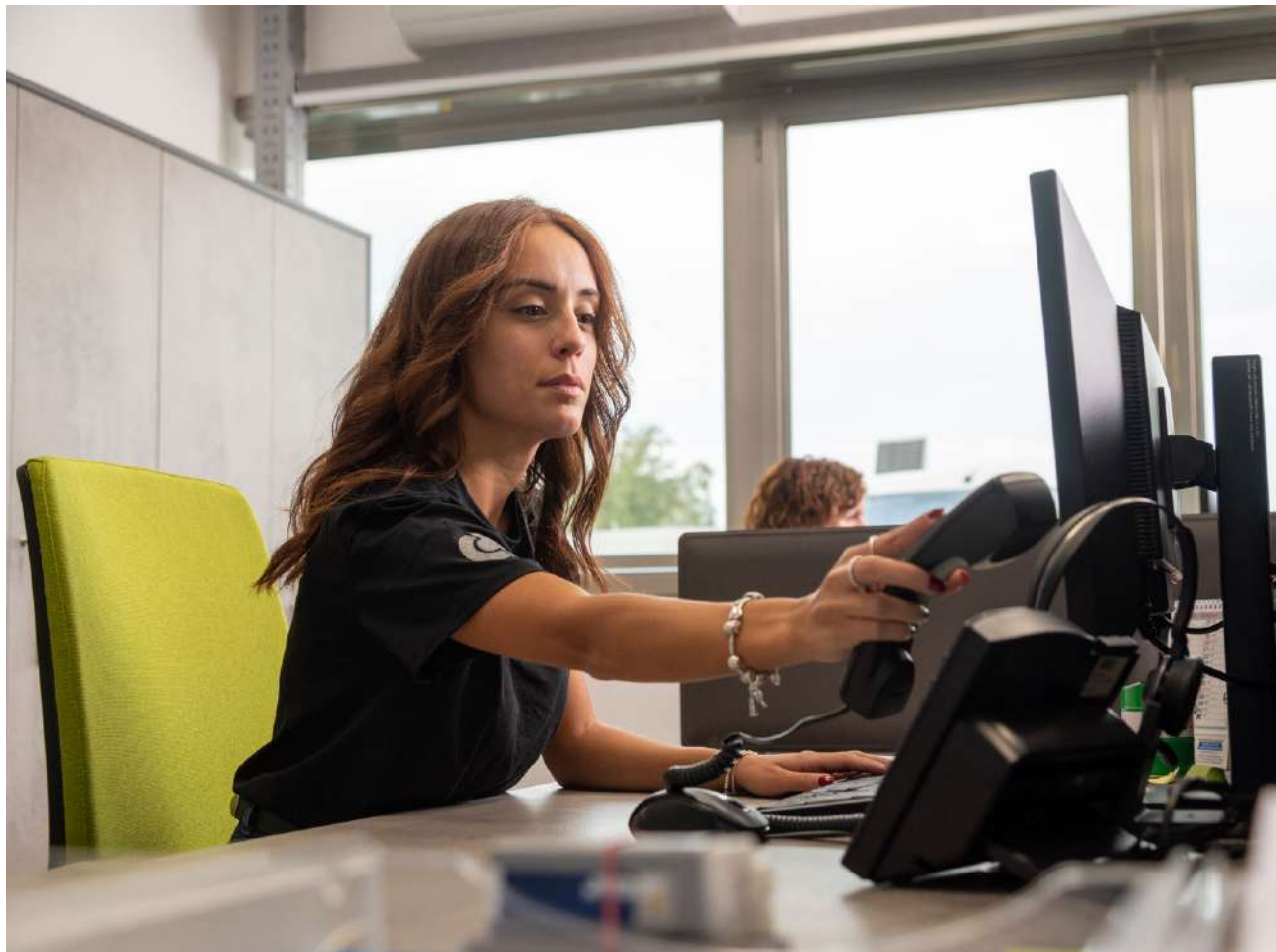

Over the years, we have learned to recognise the dynamics of our market, and we are well aware that it is often necessary to respond to requests with the smallest of turnaround times. Our in-house organisation and use of technology allow us to monitor our work flows and always have a stock of raw materials and small amounts of finished small metal parts, ready for shipping. In this way, we are able to anticipate customer requirements and help them to solve their problems.



To meet the required quality standards, we have developed a process that, beginning with a basic work list, pairs each batch of raw materials with each job and guarantees full traceability. All raw materials arrive certified and, once in the company, they are checked and identified before they can enter the production cycle: ingots - in brass, steel and aluminium, together with plastics, are marked in different colours and matched to an in-house "ID document" that will follow every job, through to delivery of the finished product.



We have also prepared careful machine-board and cycle-end inspection processes, using machinery with the highest level of precision. Our measuring instruments are coded, calibrated and certified every year, to ensure the conformity of our small metal parts with the utmost precision. That is how we back up our quality promise.

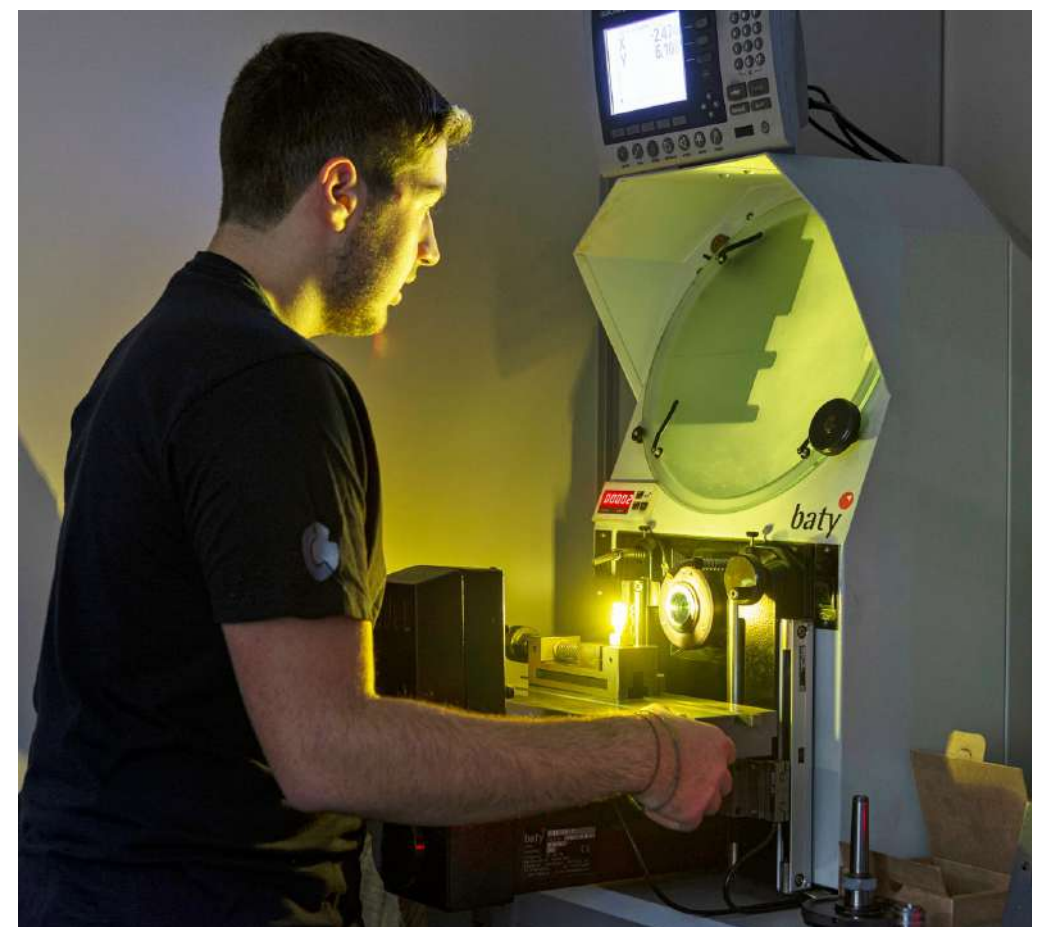
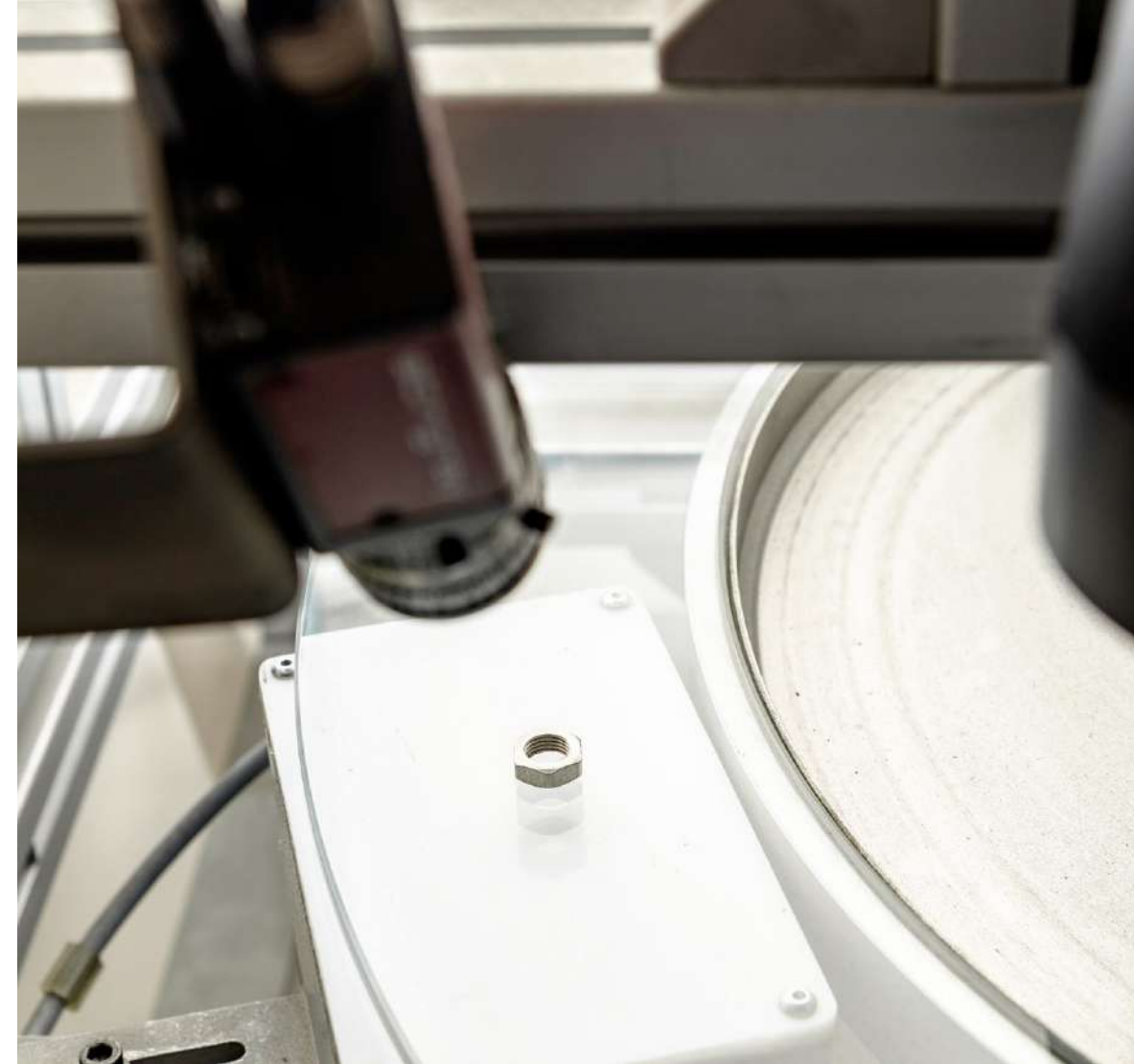

Capitani Minuterie Metalliche s.r.l. unipersonale
Via Nicolini, 19
60030 Serra de' Conti (AN)

Tel. 0731.879640

Fax 0731.870077

info@capitaniminuterie.com

www.capitaniminuterie.com



Company with ISO 9001
certified quality system

Legaly Rating | ★ ★

AGCM Autorità Garante
della Concorrenza e del Mercato



